

埼玉会館展示室寸法図

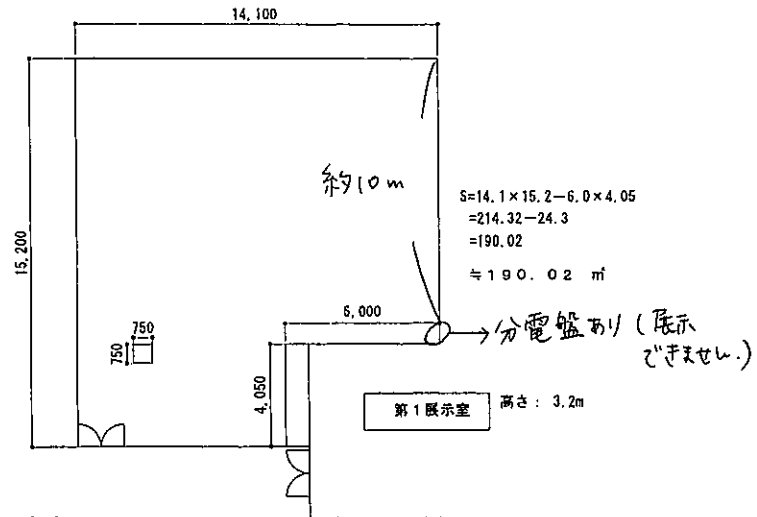

$$S=14.1 \times 15.2 - 6.0 \times 4.05$$

$$=214.32 - 24.3$$

$$=190.02$$

$$\approx 190.02 \text{ m}^2$$

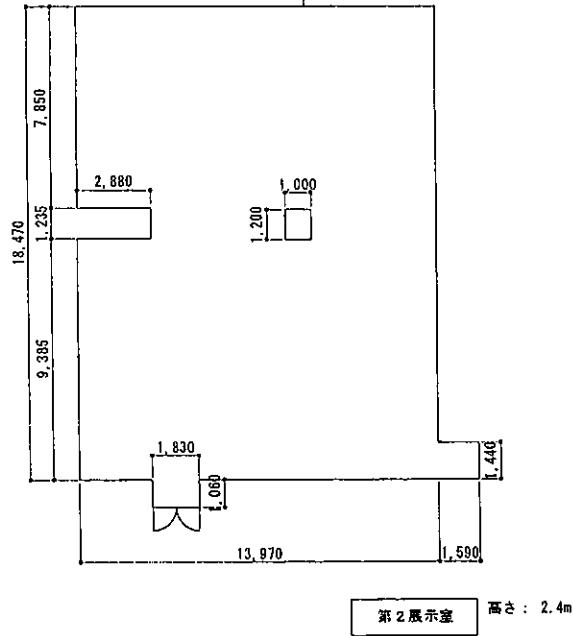

$$S=13.97 \times 18.47$$

$$=258.0259$$

$$\approx 258.03 \text{ m}^2$$

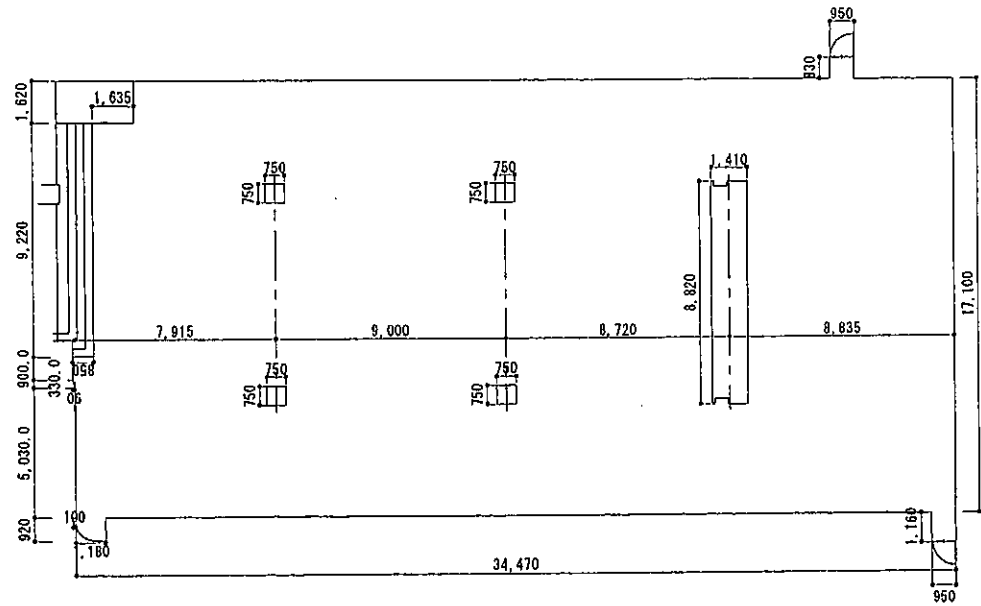

$$S=34.47 \times 17.1$$

$$=589.437$$

$$\approx 589.44 \text{ m}^2$$